

STRIJP S

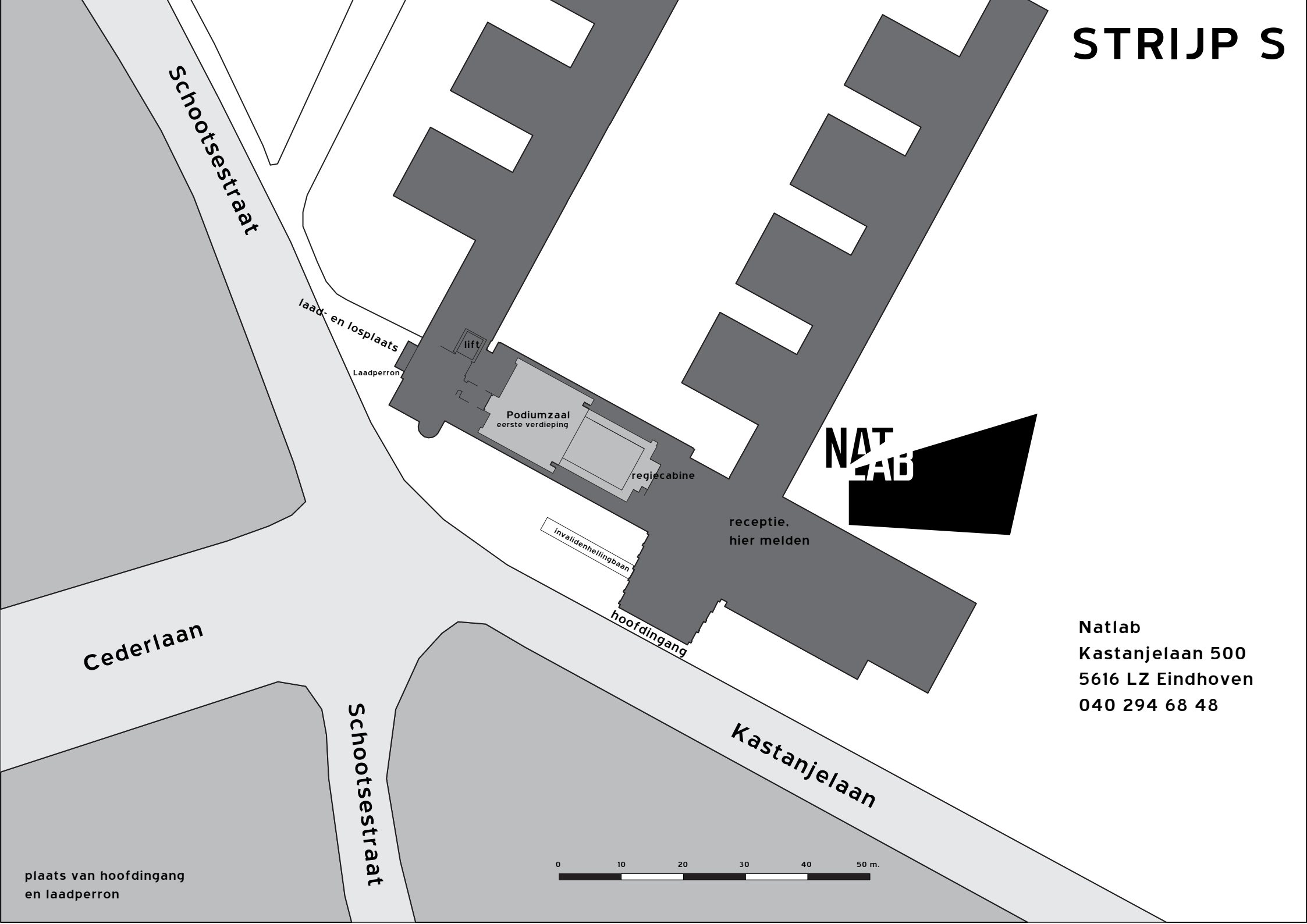

Schootsestraat

Cederlaan

Schootsestraat

Kastanjelaan

laad- en losplaats

Laadperron

lift

Podiumzaal
eerste verdieping

regiecabine

receptie.
hier melden

invalidenhellingbaan

hoofdingang

NATLAB

plaats van hoofdingang
en laadperron

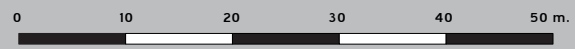

Natlab
Kastanjelaan 500
5616 LZ Eindhoven
040 294 68 48

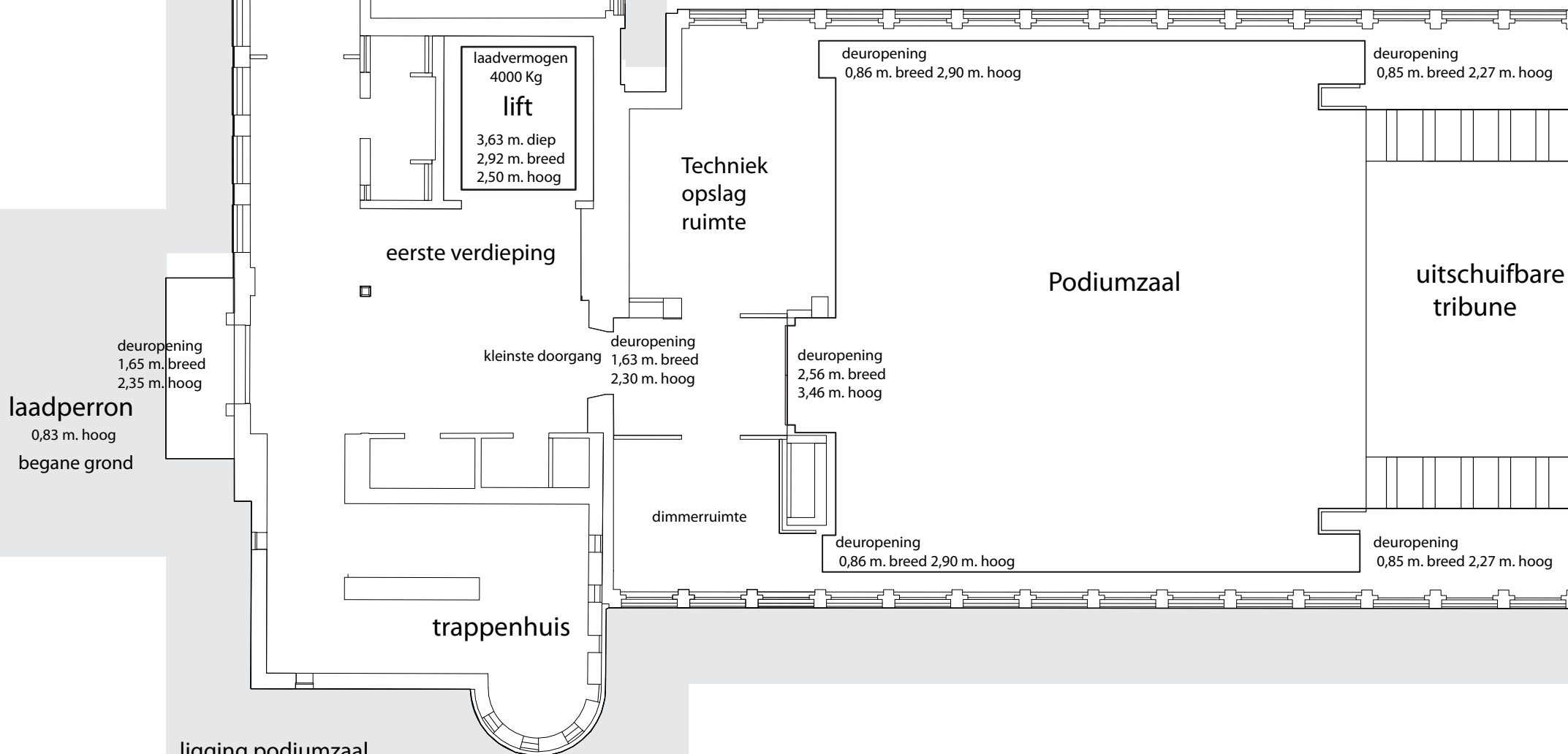

ligging podiumzaal
en bereikbaarheid met materiaal

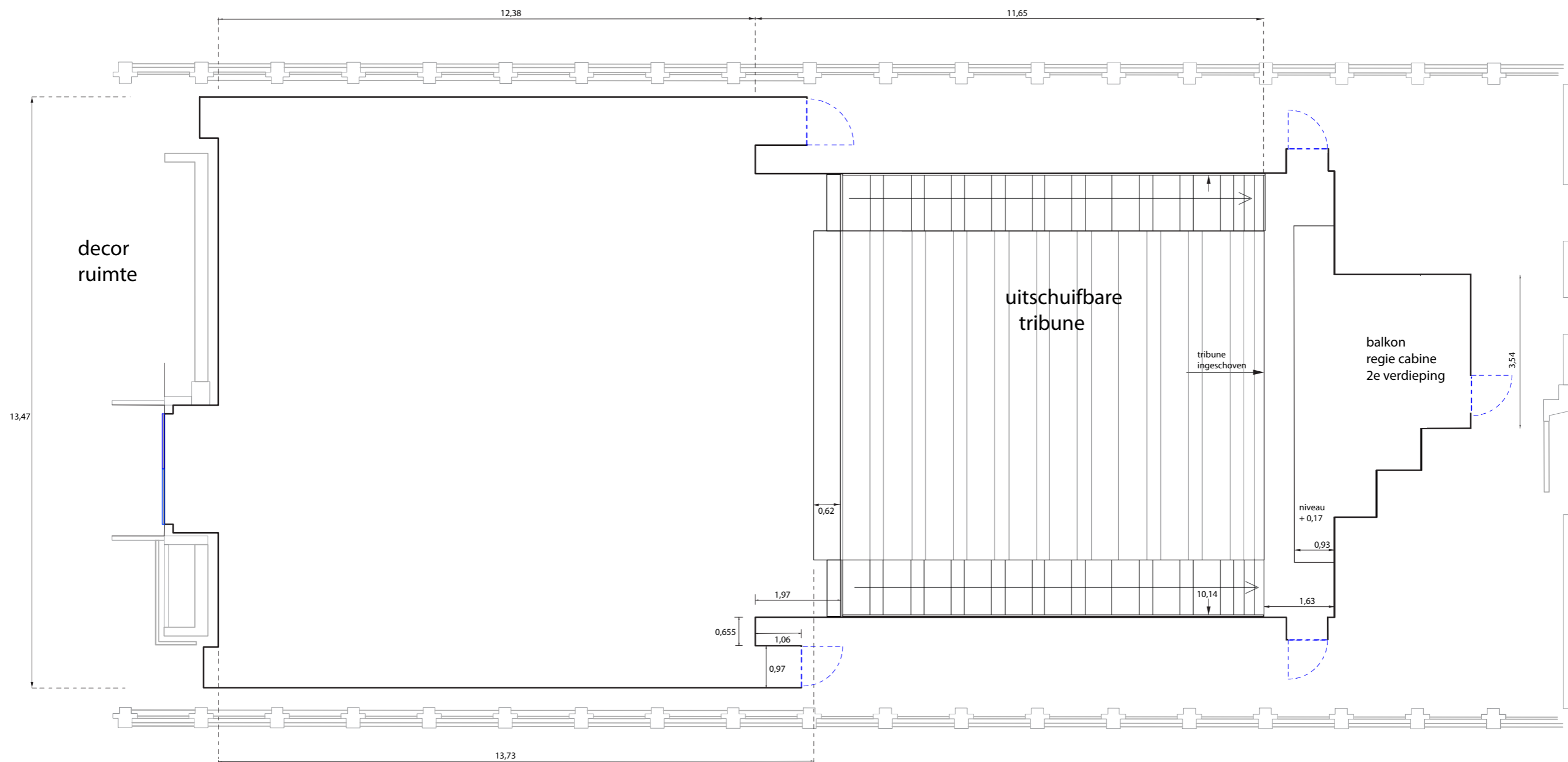

SCHAAL 1 : 100
(als pdf op A3 wordt afgedrukt)

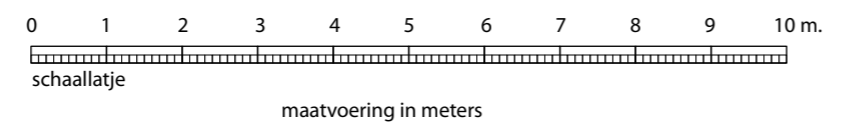

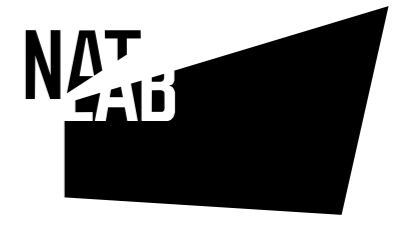

Loopbrugniveau

1,70
2,75
0,90
13,59
6,60
0,17
1,70

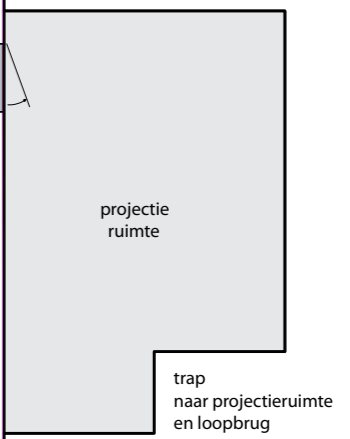
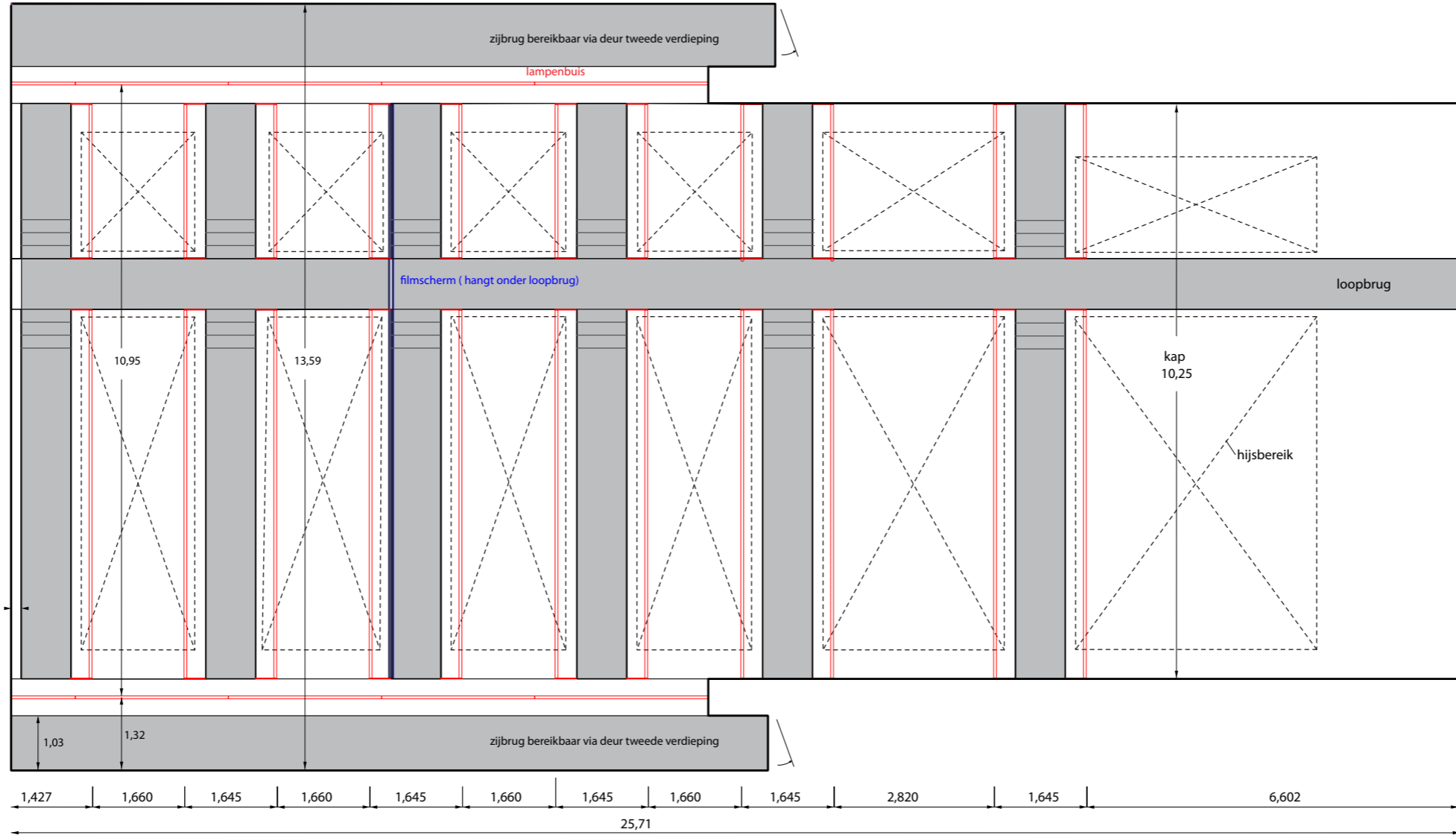

1,427 1,660 1,645 1,660 1,645 1,660 1,645 1,660 1,645 2,820 1,645 6,602
25,71

SCHAAL 1 : 100

(als pdf op A3 wordt afgedrukt)

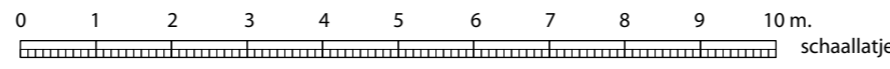

afmetingen podiumzaal

maten in meters

9,84
7,46
6,74

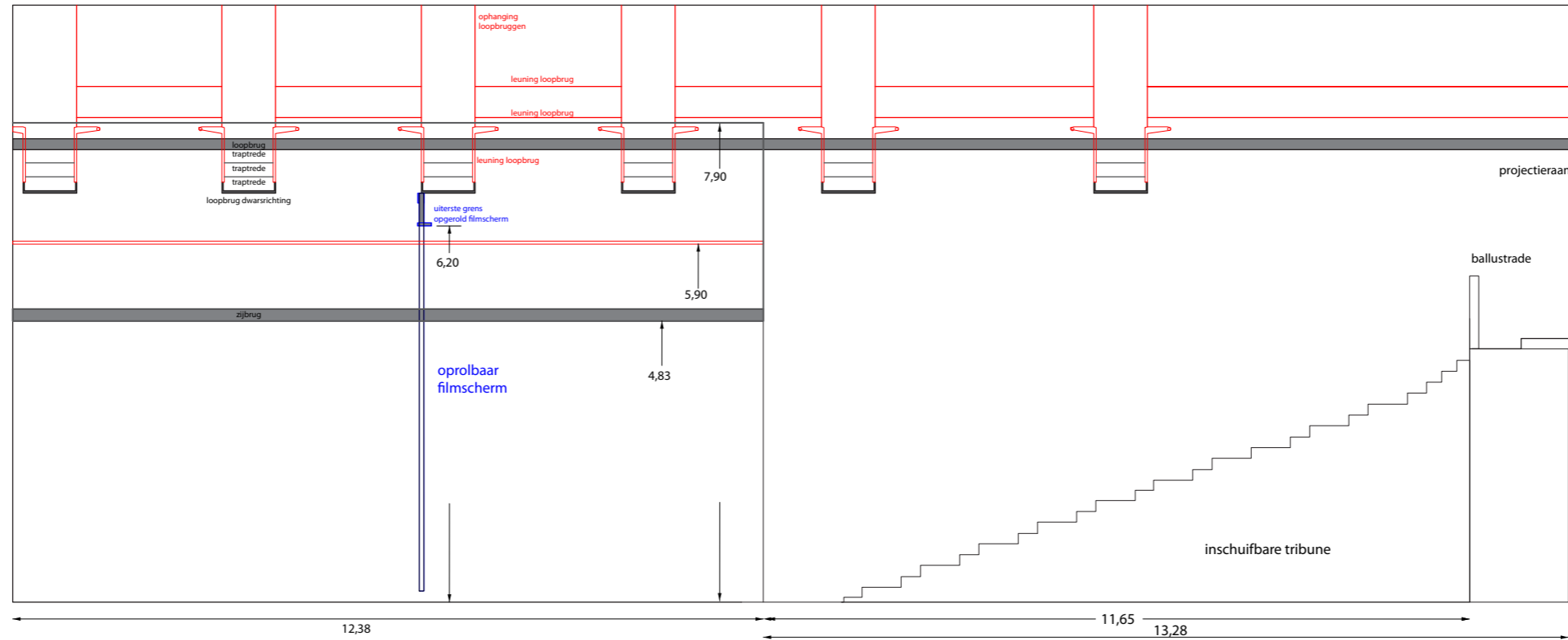

Doorsnede podiumzaal

12,38

11,65

13,28